

ATTENUATOR

COAXIAL DC-40 GHz 2.92mm 2 WATT



DATA SHEET

PART SERIES: 42KAXX.XXF

SHEET 1 of 2
Dwg 1014175

EN 15-2042
Revision A

FEATURES

- Superior Attenuation Accuracy
- Low VSWR
- Rugged Construction
- MIL-DTL-3933
- High Reliability

APPLICATIONS

- Amplifier Stabilization
- Improve VSWR Between Stages
- Balance Channels
- Overload Protection
- Set Amplification Gain/Power
- Sample Output Power
- Military

GENERAL DESCRIPTION

Florida RF Labs Coaxial Attenuators offer superior attenuation accuracy, with extended broadband frequency operation. This series is manufactured with stainless steel body and rugged construction for the most demanding environments.

ORDERING INFORMATION

Part Identifier:

42KAXX.00F

Attenuation (dB)

Environmental Compliance



SPECIFICATIONS

1.0 ELECTRICAL

Nominal Impedance: 50 ohms
Frequency Range: DC – 40 GHz
Attenuation Values Available: 0 – 6, 8, 10, 15, 20, 30

POWER AND DERATING		
-55°C to +25°C	2 WATTS	
+25°C to +125°C	0.2 WATT	
 <p>The graph shows the Safe Operating Area (SOA) for the device. The y-axis is 'RATED POWER' from 0% to 100%. The x-axis is 'TEMPERATURE IN °C' from -55 to 125. The SOA is a rectangle from -55°C to 25°C at 100% power. From 25°C to 125°C, the power is derated linearly to 0.2 W (20% of 1W) at 125°C. The area is labeled 'SAFE OPERATING AREA'.</p>		
ATTENUATION ACCURACY (dB)		
dB VALUE	DC – 26.5 GHz	26.5 – 40 GHz
0 – 6, 8	± 0.5 dB	± 0.8 dB
10, 15 & 20	± 0.6 dB	± 1.0 dB
30	± 0.8 dB	± 1.0 dB
VSWR (MAX)		
DC- 18 GHz	18 - 40 GHz	
1.30:1	1.40:1	

ATTENUATOR

COAXIAL DC-40 GHz 2.92mm 2 WATT



DATA SHEET

PART SERIES: 42KAXX.XXF

SHEET 2 of 2
Dwg 1014175

EN 15-2042
Revision A

2.0 ENVIRONMENTAL

Operating Temperature:	-55°C to +150°C
Non-operating Temperature:	-65°C to +150°C
Temperature Coefficient:	+/-200 PPM / °C max

3.0 MARKING

Unit Marking:	FRFL, Part Number dB value & 40 GHz
---------------	--

4.0 QUALITY ASSURANCE

Sample Inspect Per MIL-STD-105, Level II, 1.0% AQL.

Visual and Mechanical Examination for Conformance to Outline Drawing
Measure Attenuation and VSWR
Data Retention – Standard

5.0 PACKAGING

Standard Packaging:	Tube
---------------------	------

6.0 MECHANICAL

Body and Nut Material:	Passivated Stainless Steel
Body and Nut Finish:	Passivated Stainless Steel
Center Contact Material:	Beryllium Copper
Center Contact Finish:	Gold
Dielectric:	PTFE
Resistive Element:	Thin Film
SMA Interface:	Female/Male
Torque:	7.0 – 8.0 lbs.in
Metric Dimensions:	Provided for reference only

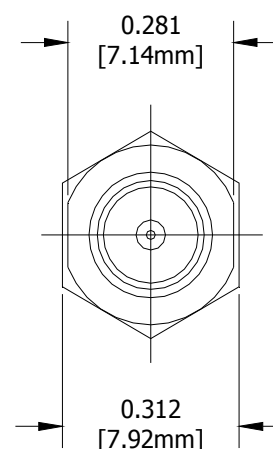
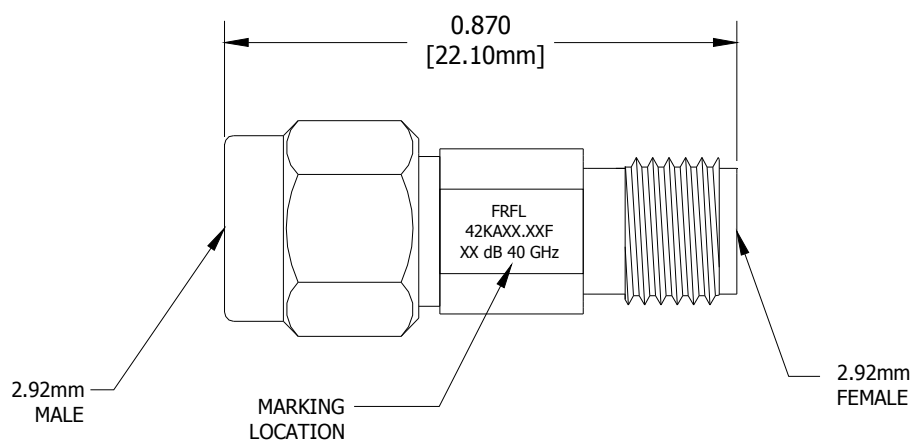

Unless Otherwise Specified: TOLERANCE: X.XXX = ± 0.005